

[RFID ear tags for cattle](#) is helpful for animal husbandry information management, and it can track and trace to the source for animal breeding, epidemic prevention and control, meat quarantine and other conditions effectively, find the diseases and epidemics timely, and solve it to reduce losses and improve the efficiency of farming.

Application: mainly used in animal husbandry tracking identification management, such as pigs, cattle, sheep and other livestock.

**Technical Specification:**

Item:	rfid ear tags for cattle
Material:	TPU
Size:	43.5*51mm, 100*74mm or customized
Color:	yellow(customized)
Chip:	EM4100, TK4100, EM4305, HiTag-S256, T5577, TI Tag, Ultralight, I-CODE 2, NTAG213, Mifare S50, Mifare S70, FM1108.
Operating temperature:	-10°C~+70°C
Storage temperature:	-20°C~+85°C
Frequency:	125KHZ/13.56MHZ/860MHZ
Protocol:	ISO18000-6B, ISO-18000-6C (EPC Global Class1 Gen2)
Reading range:	2CM~50CM~Depend on actual environments and readers~
Operating mode:	read/write
Data storage time:	~10 years



# HOW LIVESTOCK RFID WORKS

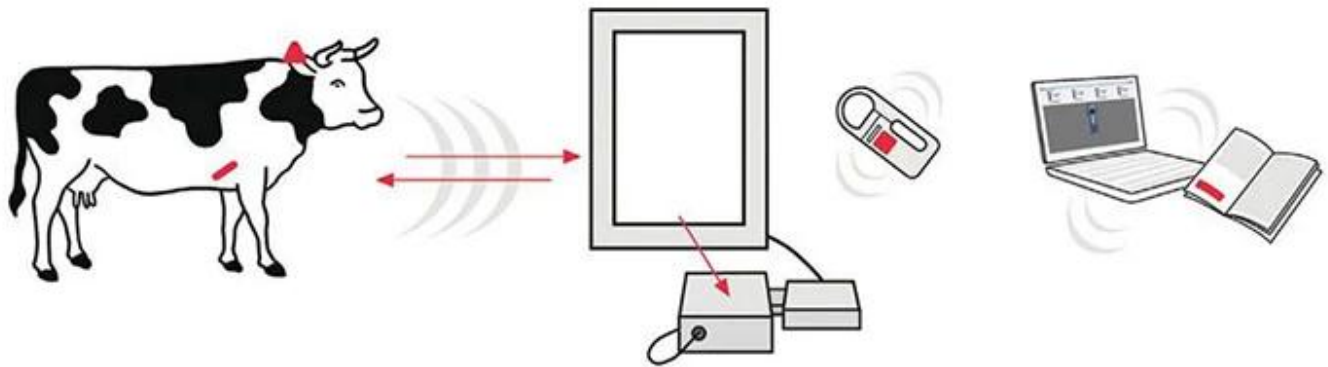

**1.** Apply ear tags to, and/or implant boluses in your animals

**2.** Read RFID identification codes to track individual animals using Datamars portable readers or raceway antennas

**3.** Use the included software to integrate data seamlessly to your livestock management system

**Our Company And Factory**

# Company Introduction

## Office

3,000 m<sup>2</sup> office, 250+ professional sales service you!



Shenzhen Great Creativity Smart Card Co.,Ltd.

## Factory

12,000m<sup>2</sup> clean work shop, more than 500 staffs, strict QC system, full set of advanced machines for all kinds of crafts production, ensuring each order will be taken cared fast and well.

