

[Electronic ear tags for cattle](#) are installed on the animal ears with the special animal ear caliper while installing, then can be used normally. The electronic ear tags are made of non-toxic, no smell, no stimulation, non-polluting plastic materials. Effectively prevent damage from the organic acid, water salt, mineral acid.

Application: mainly used in animal husbandry tracking identification management, such as pigs, cattle, sheep and other livestock.

Technical Specification:

Item:	electronic ear tags for cattle
Material:	TPU
Size:	43.5*51mm, 100*74mm or customized
Color:	yellow or customized
Chip:	EM4100, TK4100, EM4305, HiTag-S256, T5577, TI Tag, Ultralight, I-CODE 2, NTAG213, Mifare S50, Mifare S70, FM1108.
Operating temperature:	-10°C~+70°C
Storage temperature:	-20°C~+85°C
Frequency:	125KHZ/13.56MHZ/860MHZ
Protocol:	ISO18000-6B, ISO-18000-6C (EPC Global Class1 Gen2)
Reading range:	2CM~50CM~Depend on actual environments and readers~
Operating mode:	read/write
Data storage time:	~10 years



HOW LIVESTOCK RFID WORKS

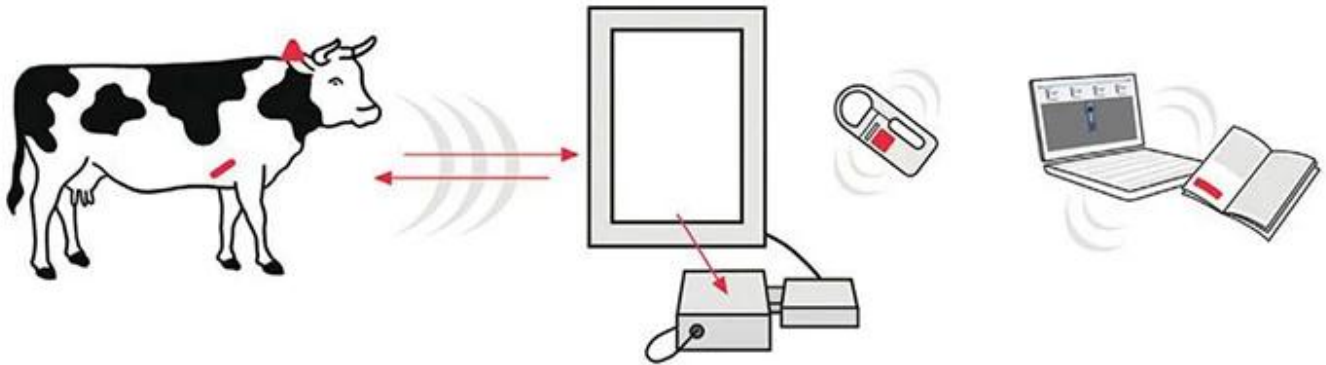

1. Apply ear tags to, and/or implant boluses in your animals

2. Read RFID identification codes to track individual animals using Datamars portable readers or raceway antennas

3. Use the included software to integrate data seamlessly to your livestock management system

Our Company And Factory □

Company Introduction

Office

3,000 m² office, 250+ professional sales service you!



Shenzhen Great Creativity Smart Card Co.,Ltd.

Factory

12,000m² clean work shop, more than 500 staffs, strict QC system, full set of advanced machines for all kinds of crafts production, ensuring each order will be taken cared fast and well.

