

[RFID 000-000](#) RFID 000 000 0 0 0000 0000 0000 000 0 0 00 00, 0000 00 0 000, 00 00 0 0000 0 0 0000 0 00 0 00000 000000, 00 0 0000, 00 0000 0000 0000 0000 0000 0000 0000 00.

00 0000: 00 00 00 00, 00 00, 0, 0, 00 0000 00 00 00.

00 00:

00:	rfd 00 0 0 00
00:	TPU
00:	43.5 * 51 0000, 100 * 74 mm 00 0000 00
0:	0 (0000 00)
0:	EM4100, TK4100, EM4305, HiTag-S256, T5577, TI 00, 0000, 00 0 0 2, NTAG213, Mifare S50, Mifare S70 FM1108.
00 00:	-10 °C ~ + 70 °C
00 00:	-20 °C ~ + 85 °C
0000:	125KHZ/13.56MHZ/860MHZ
00000:	ISO18000-6B, ISO 18000-6 C (EPC 0000 Class1 Gen2)
00 00:	2 CM ~ 50 CM (00 0000 0000 00 000000)
00 00:	00/00
0000 00 00:	> 10 0



HOW LIVESTOCK RFID WORKS

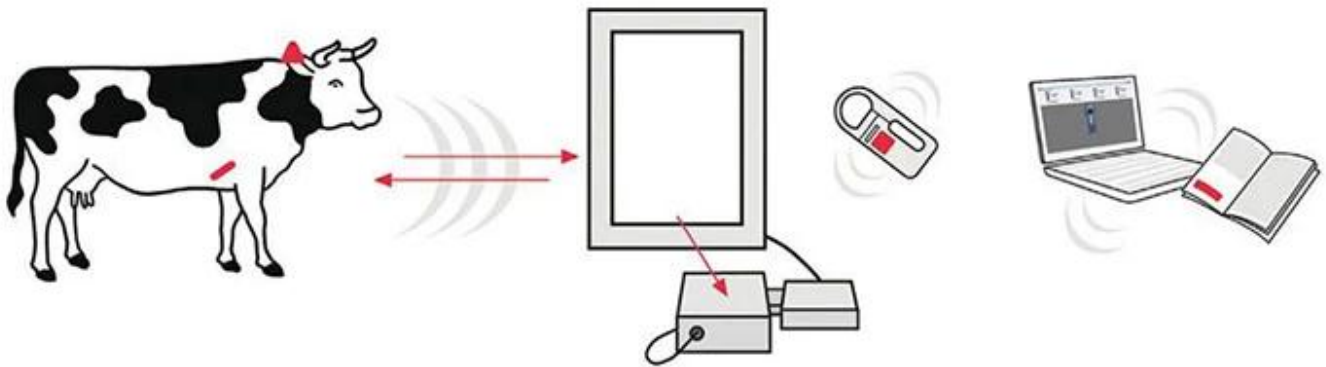

1. Apply ear tags to, and/or implant boluses in your animals

2. Read RFID identification codes to track individual animals using Datamars portable readers or raceway antennas

3. Use the included software to integrate data seamlessly to your livestock management system